

FORM NO. 1.

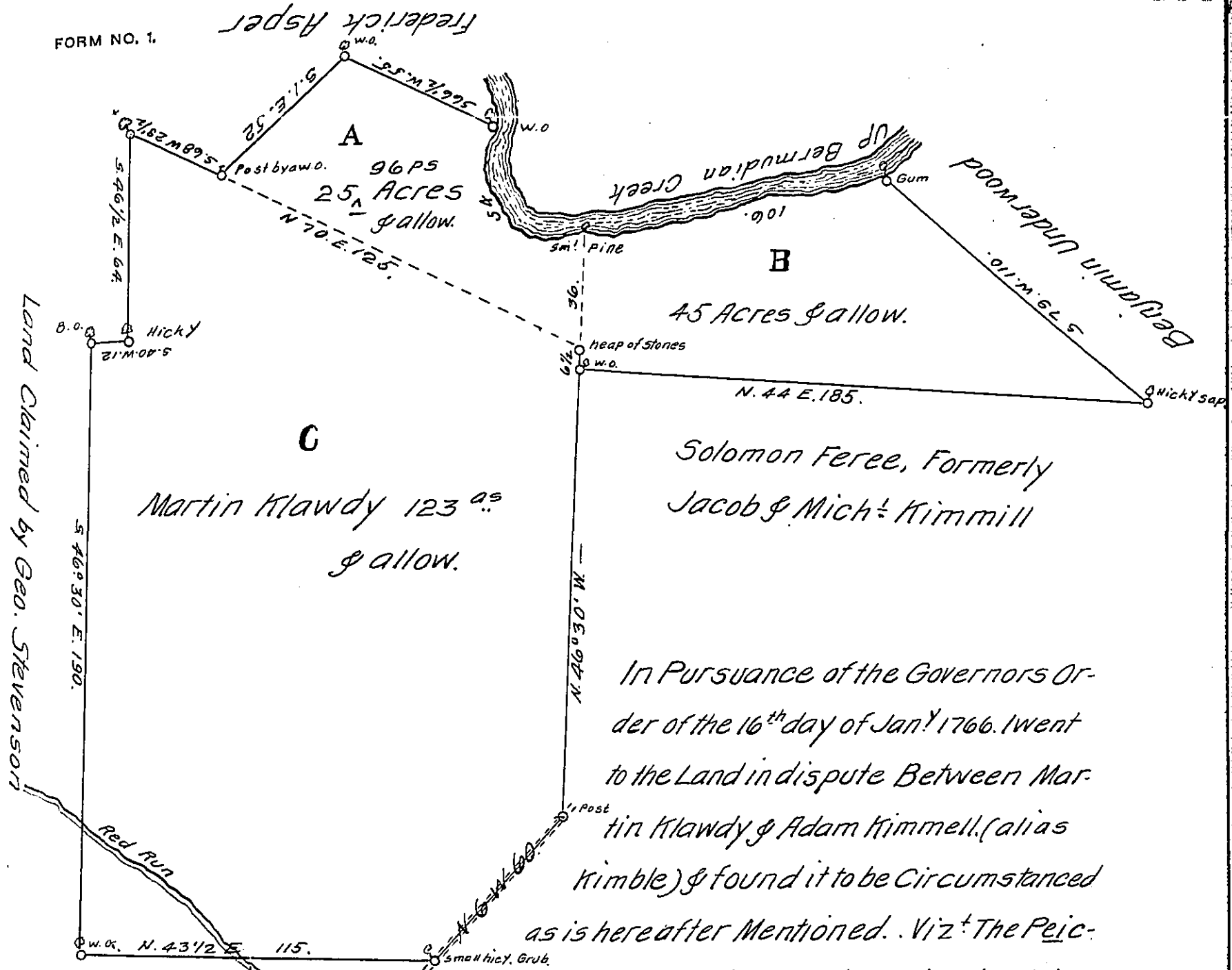

Land Claimed by Geo. Stevenson

Martin Klawdy 123<sup>as</sup> & allow.

Solomon Feree, Formerly Jacob & Mich<sup>ls</sup> Kimmill

In Pursuance of the Governors Order of the 16<sup>th</sup> day of Jan<sup>y</sup> 1766. I went to the Land in dispute Between Martin Klawdy & Adam Kimmell (alias Kimble) & found it to be Circumstanced as is hereafter Mentioned. Viz<sup>t</sup> The Pieces marked A & B. Adam Kimble Claims under his Warrant of the 11<sup>th</sup> of October

Claimed by George Stevenson 5<sup>oy</sup> 1753 & the Pieces marked A & C. Martin Klawdy Claims Under his Warrant of the 28<sup>th</sup> of Aug<sup>t</sup> 1742. There is an old Line of marked Trees from the heap of Stones to the Creek which is said to have been made by the former Possesser of Kimble's Land & Klawdy as a Partition Between them. Situate in Reading Township in the County of York. Surveyed the Pieces A & C. for Martin Klawdy the 5<sup>th</sup> of December 1765. The Piece marked B. was Surveyed the 26<sup>th</sup> of March A. D. 1766.

Chas Lukens D.S.

To John Lukens Esq<sup>r</sup> Survey<sup>r</sup> Gen<sup>l</sup>

IN TESTIMONY that the above is a copy of the original remaining on file in the Department of Internal Affairs of Pennsylvania, made conformably to an Act of Assembly approved the 16th day of February, 1833, I have hereunto set my Hand and caused the Seal of said Department to be affixed at Harrisburg, this first day of March 1912.

*Henry Horvath*  
Secretary of Internal Affairs.